

REF : BOSKOVIC

Goélette de luxe de 32 m



Caique de 32,9 m construit en 2006

(10 pers. : 5 cabines dont 2 masters)















Plan

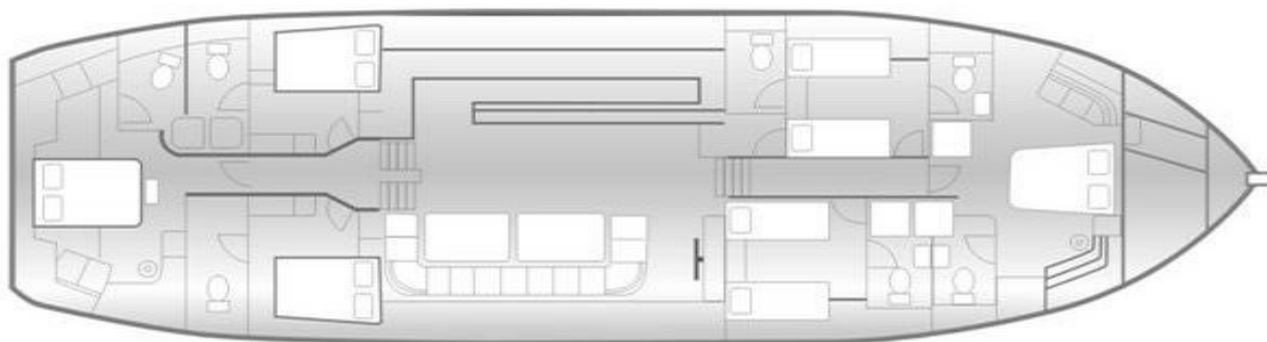

Votre capitaine : *Peter*



(notre photo, 28 juin 2008)

EMBARQUEMENTS/DEBARQUEMENT :

- Le mieux est le port de TROGIR (5km de l'aéroport)
- Sinon SPLIT (25 km de l'aéroport)
- Ou DUBROVNIK

SPECIFICATIONS :

Year of production	2006
Length over all	29.5 m
Beam	7.3 m
Draft	3 m
Engine	IVECO AIFFO 450 HP turbo deisel
Fuel tank	2400 l
Water tank	10000 l
Cabins	5
Berths	10
Showers/toilettes	5
Additional:	Jet-skis

T A R I F S 2 0 1 0

29/Mai -----	to --	26/Juin	=	25 350 €
27/Juin -----	to --	12/Septembre	=	27 300 €
11/Septembre ---	to --	02/Octobre	=	25 350 €
02/Octobre ----	to --	16/Octobre	=	23 500 €
16/Octobre -----	to--	01/Janvier	=	21 500 €

ALL INCLUSIVE OPTION (obligatoire) :

Breakfast, Lunch, Dinner, all Drinks, Port/Harbour taxes and use of all equipment on the yacht (Jet-ski extra)

= 710 € /person/week ou half board : **630 €/person/week**

SUPER ALL INCLUDED :

Included the best Croatian wines and food
(scamps lobsters and fish and another food from the market)

= 1.370 € PER PERSON PER WEEK

➤ Extra :

- National Parks' entrance fess,
 - 1 500 € per week for use JET-SKIS or 250 € per day + gasoline
-

